

VOLUME

2

OCTOBER 2020





# Teorema

*"a non-self-evident statement that  
has been proven to be true..."*

Bauhaus inspired, the Teorema collection is more than a series of tables. Ana Carreras designs, are first art pieces. The pure simple lines add to the lightness of the structures that become anti-gravity sculptures, that appear floating in the air. Ana Carreras took basic geometrical forms and transformed it into an object, that metamorphoses itself depending on the angle of vision. She brought her energy and talent to create a modern yet timeless piece of contemporary art.

Designed by  
Ana Carreras





Pitagora





# Pitagora

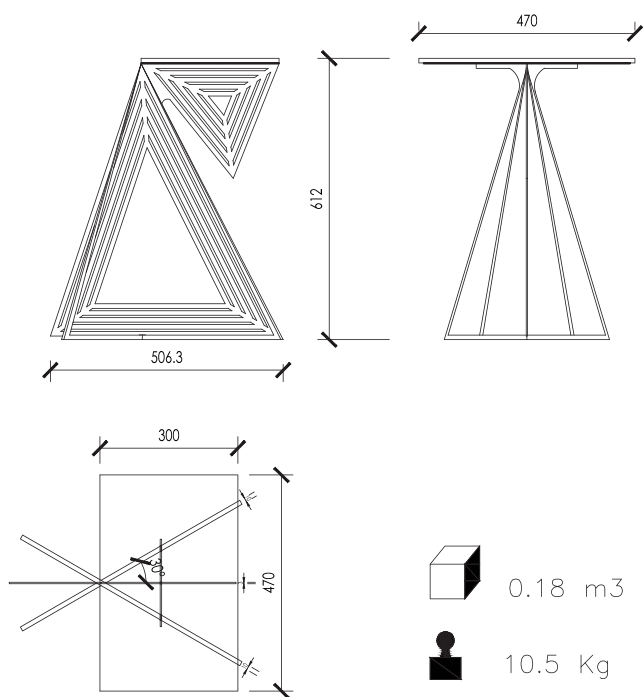

0.18 m<sup>3</sup>



10.5 Kg

Mirage top:



JW-02



JW-09



JW-12



JW-16



JW-17



CP-03



CP-04



CP-05



CP-06



CP-07





Pitagora





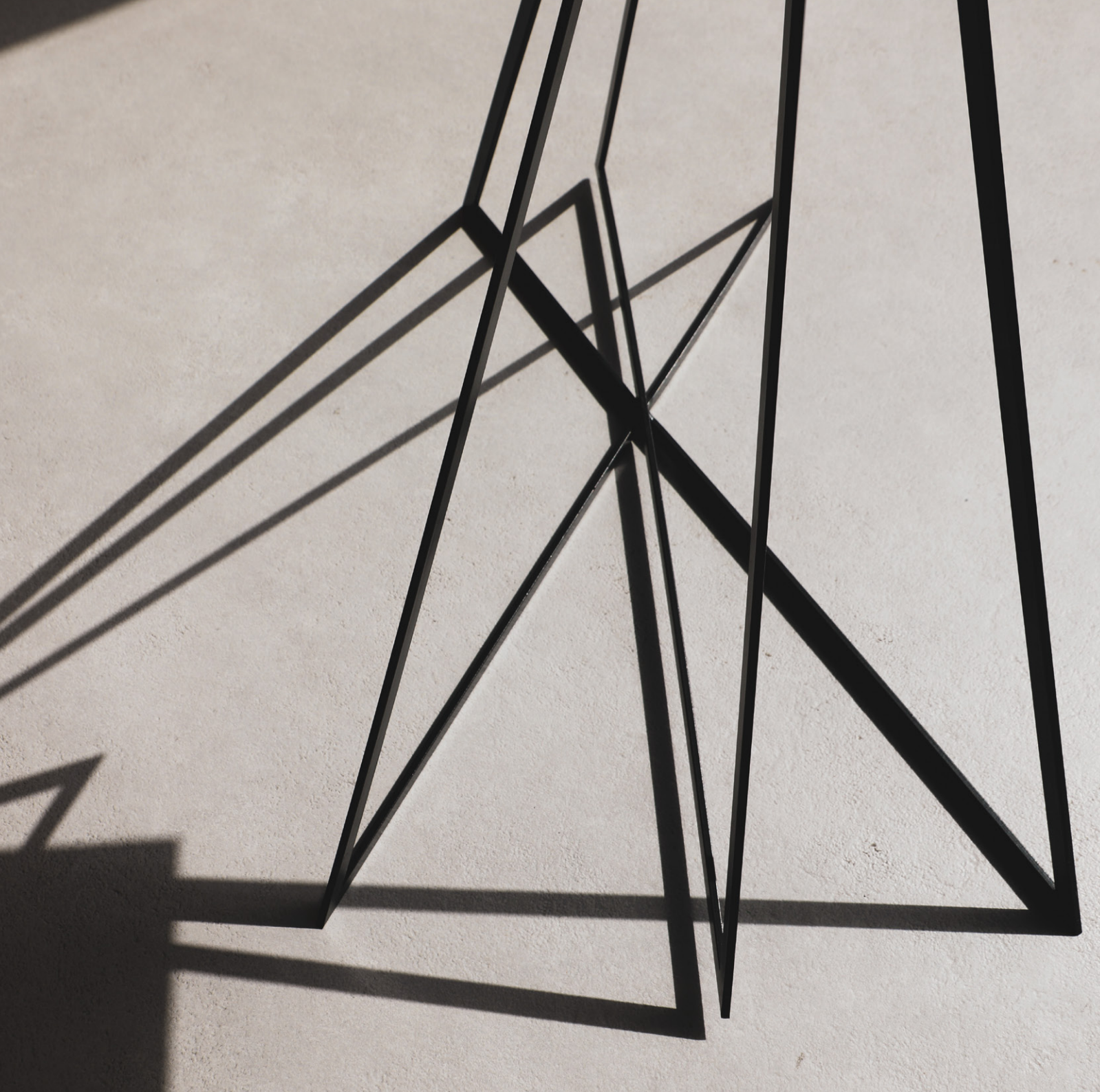

**Meridiana**





# Meridiana

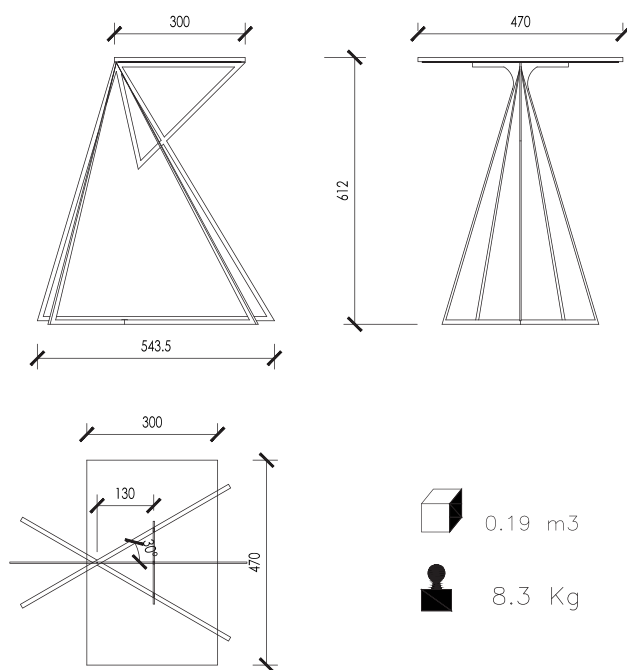

Mirage top:



Meridiana

lever



# Parabola







# Parabola



0.2 m<sup>3</sup>



32.5 Kg

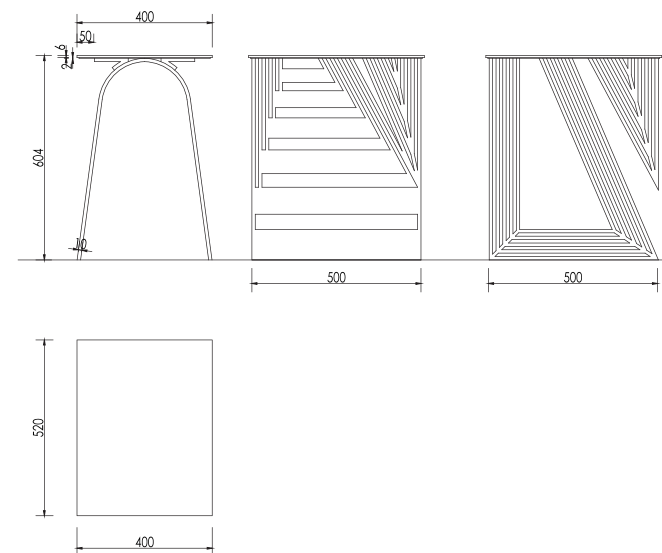

Mirage top:



JW-02



JW-09



JW-12



JW-16



JW-17



CP-03



CP-04



CP-05



CP-06



CP-07





Parabola



# Pitagora Bold

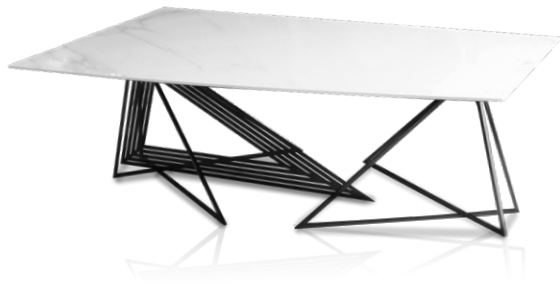



# Pitagora Bold

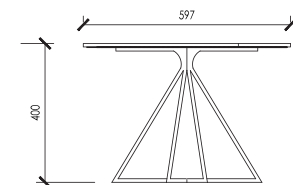
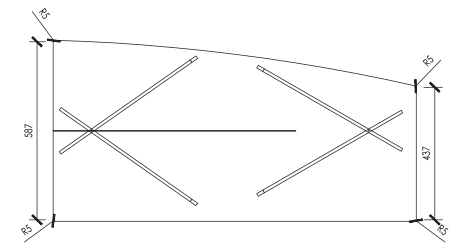
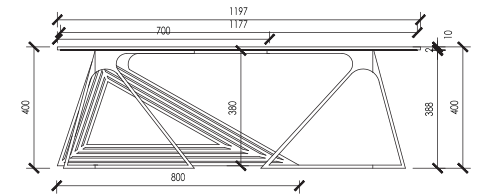

0.38 m<sup>3</sup>

34 Kg

Mirage top:



JW-02



JW-09



JW-12



JW-16

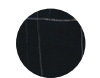

JW-17



CP-03



CP-04



CP-05



CP-06



CP-07





Pitagora Bold





Pitagora Bold





Anello



# Anello



0.25 m<sup>3</sup>



6.5 Kg

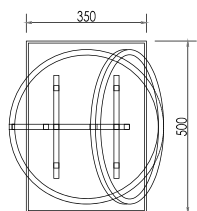
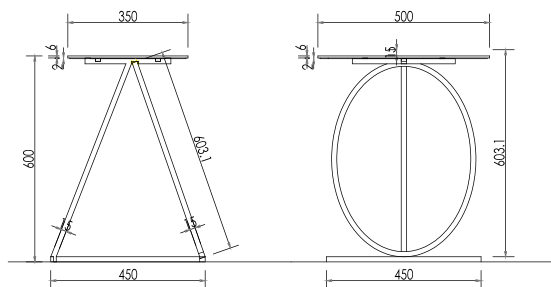

Mirage top:



JW-02



JW-09



JW-12



JW-16



JW-17



CP-03



CP-04



CP-05



CP-06



CP-07







Anello





Helix





# Helix

 0.65 m<sup>3</sup>

 48 Kg

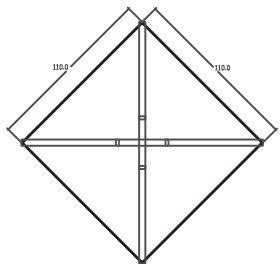

Mirage top:



JW-02



JW-09



JW-12



JW-16



JW-17



CP-03



CP-04



CP-05



CP-06



CP-07







Helix



Nucleus







# Nucleus

 3.1 m<sup>3</sup>

 95 Kg

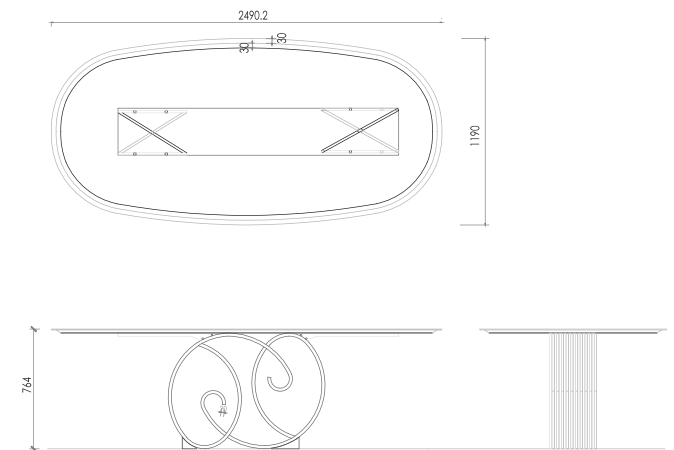

Mirage top:

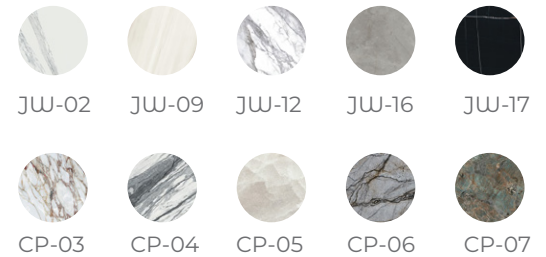





Nucleus



# Poetry

*"...work in which the expression of feelings is given intensity by the use of distinctive style..."*

The Poetry collection is first an ode to nature and beauty. It is a series of three flower bouquets as seen through the eyes of Ana Carreras. Each design is a poem painted by Ana Carreras in homage to mother earth.

The elegant silhouettes come waltzing together to recreate a scene of burgeoning red poppies on a windy spring day, at the banks of the Ebro river. They dance joyfully in pairs, in a frozen time space, in an eternal embrace of love.

Designed by  
Ana Carreras







Tercet A



# Tercet A

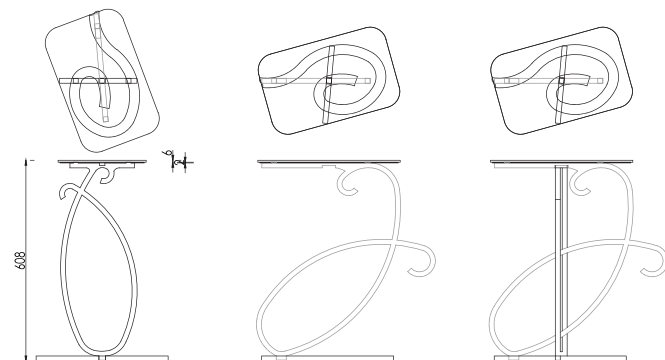
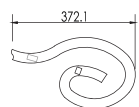
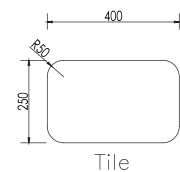

Mirage top:



JW-02



JW-09



JW-12



JW-16



JW-17



CP-03



CP-04



CP-05



CP-06



CP-07





Tercet A





Tercet A





# Tercet B







# Tercet B

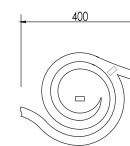
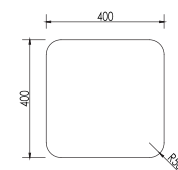

0.16 m<sup>3</sup>

8.2 Kg

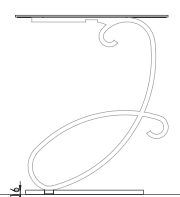
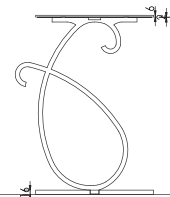
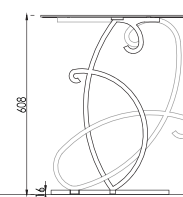
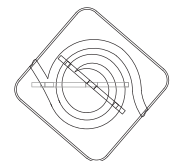
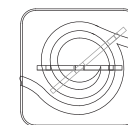
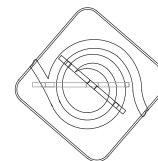

Mirage top:



JW-02



JW-09



JW-12



JW-16



JW-17



CP-03



CP-04



CP-05



CP-06



CP-07



Tercet B





Tercet C





# Tercet C



0.13 m<sup>3</sup>



6.0 Kg

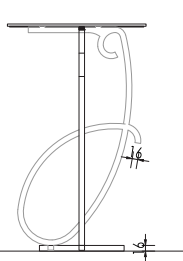
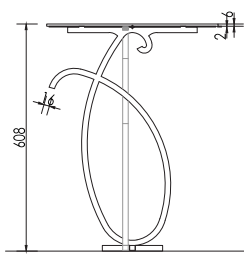
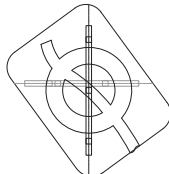
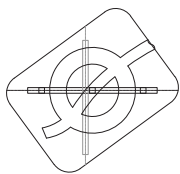
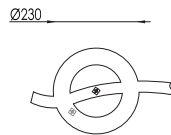
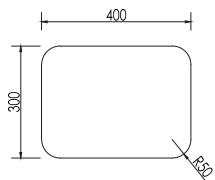

Mirage top:



JW-02



JW-09



JW-12



JW-16



JW-17



CP-03



CP-04



CP-05



CP-06



CP-07







Tercet C



Tercet C





Poetry









# Tray Sinus

Designed by  
Ana Carreras







Tray  
Heart





Designed by  
Ana Carreras

Born to a father diplomat and a mother mathematician, Ana grew up traveling the world carrying in her suitcase the smell of the bread of her grandfather's bakery in her small town of Navarra in the north of Spain.

Rebellious by nature, she cultivated a love for arts and design from her teen years, refusing to self-impose mainstream doctrines and preconceived rules.

She attended Universidad Europea in Madrid and graduated with a Master of Architecture; a period that turned out to be pivotal in her life, during which she acquired the skills of taming her outbursts of creativity without losing her free-thinking approach to design.

Ana's style is hard to label or classify. Its main characteristics remain an often-chaotic cocktail of pure simple lines or shapes, that paradoxically entangle to produce post-modern pieces of art.









L3837 Studio - Division of  lever

---

Mirage Boutique, D3-Dubai Design District,  
BLDG 7, R05, Tel: +971 4 554 3944  
P.O Box 10870, Dubai, UAE